



**VIUDES 45**  
**GENERAL SPECIFICATION**

## **SPECIFICATIONS VIUDES 45**

<b>BUILDER:</b>	VIUDES YACHTS
<b>ARCHITECTURE:</b>	ISONAVAL Naval Architects
<b>INTERIOR DESIGN:</b>	Studio of Aldo Cichero
<b>CLASSIFICATION:</b>	Lloyds Register + 100A1 MCH MCA LY2
<b>L.O.A.:</b>	44.8 M
<b>BEAM:</b>	9.5 M
<b>DRAFT:</b>	2.6 M
<b>DISPLACEMENT:</b>	420 T
<b>GROSS TONAGE:</b>	499 T
<b>ENGINES:</b>	2XCAT32 Acert-B 1318 HP at 2100 rpm
<b>GENERATORS:</b>	1x Kohler 125 kW 1x Kohler 100 kW 1x Kohler 50 kW
<b>ELECTRICITY:</b>	220V AC 50 Hertz / 24V DC System.
<b>BOW THRUSTER:</b>	Electrical 100kW
<b>STABILIZERS:</b>	2x Quantum 1800, 4 meter fins Zero Speed
<b>AIR CONDITIONING:</b>	400 BTU
<b>MAX. SPEED:</b>	15 knots
<b>CRUISING SPEED:</b>	14.5 knots
<b>RANGE:</b>	3000 nm at 14.5 knots 5000 nm at 12 knots
<b>FUEL CAPACITY:</b>	80.000 liters
<b>FRESH WATER:</b>	12.000 liters
<b>PASSENGERS:</b>	12 in 6 cabins
<b>CREW:</b>	9 in 5 cabins

# VIUDES 45 GENERAL ARRANGEMENT

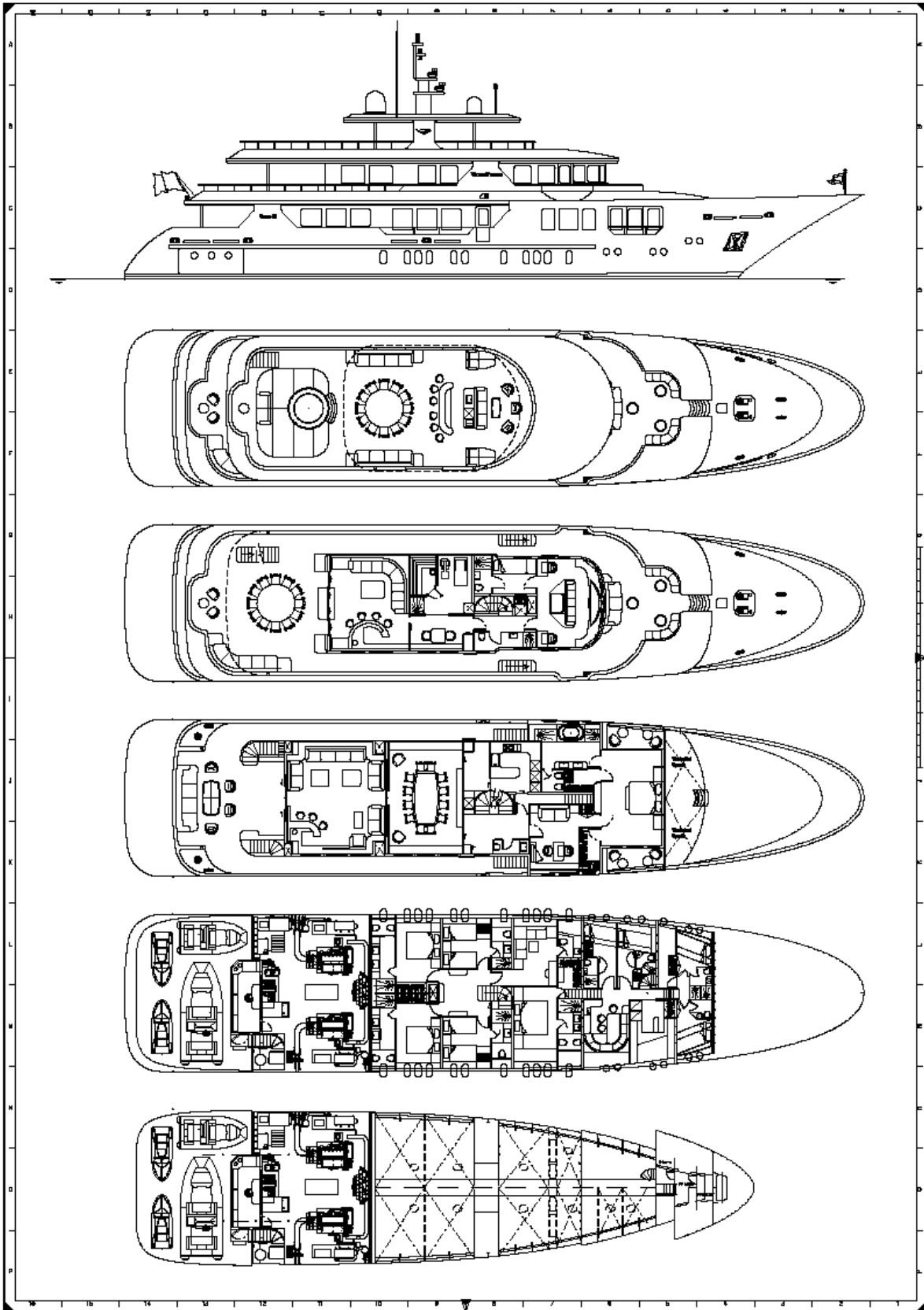

**LAYOUTS UPPER DECK**

**Option A:**

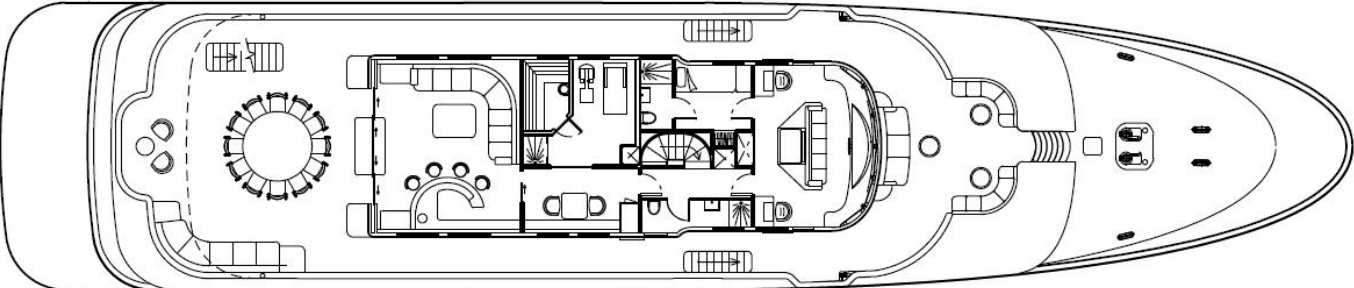

**Option B:**

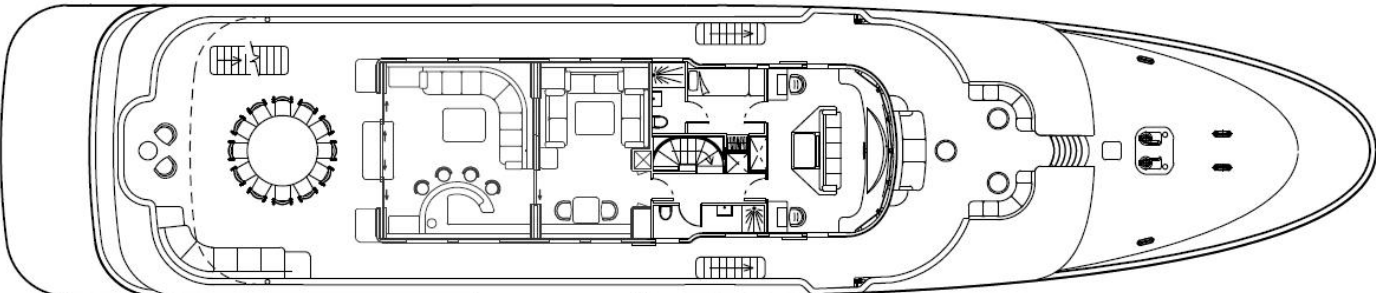

**Option C:**

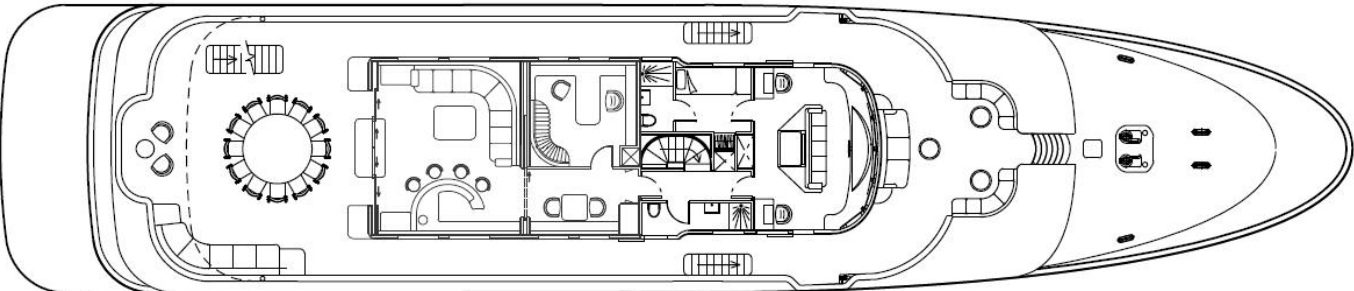

# LAYOUTS MAIN DECK

**Option A:**

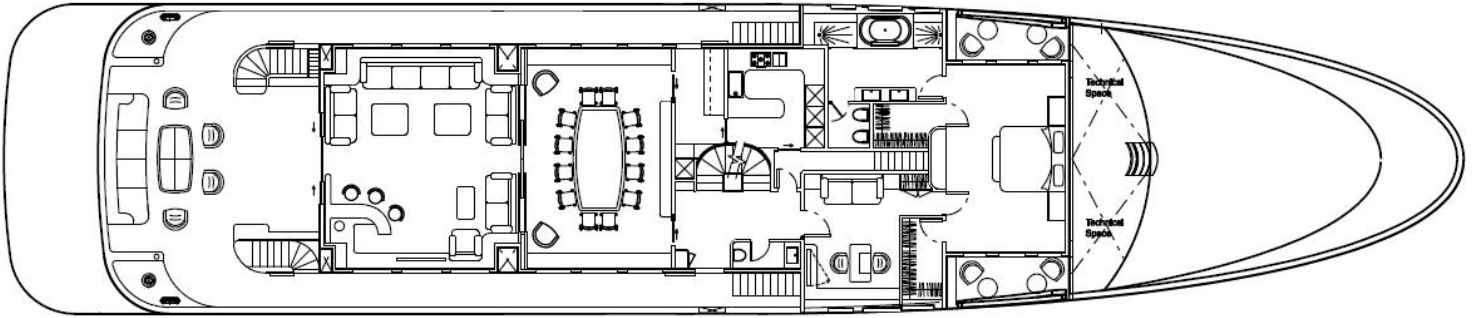

**Option B:**

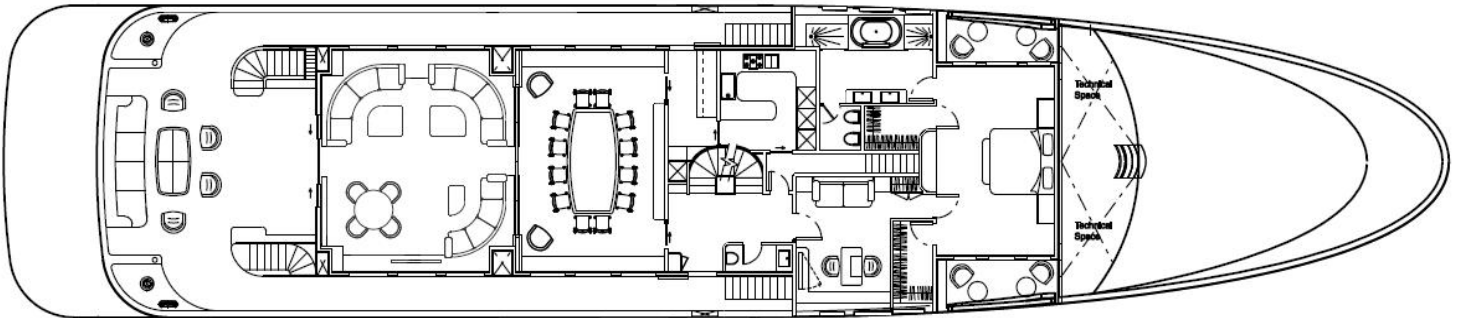

**Option C:**

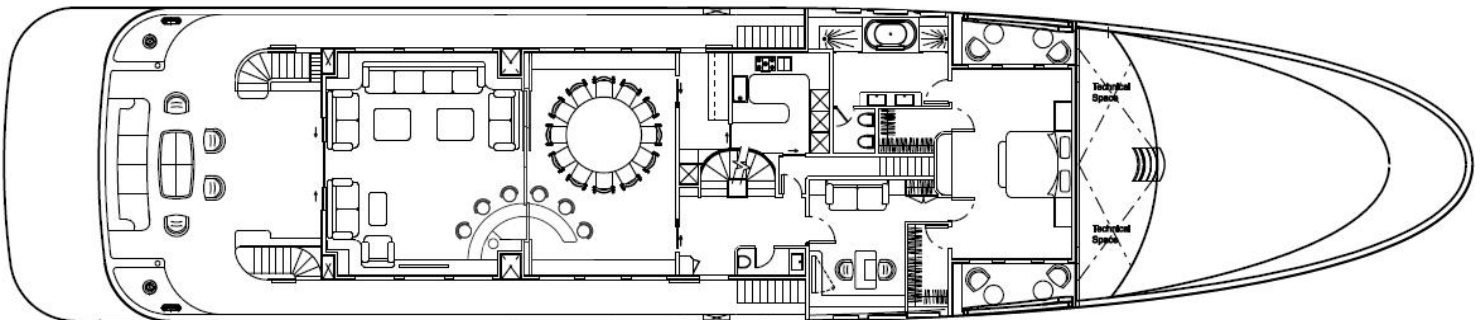

## LAYOUTS LOWER DECK

Option A:

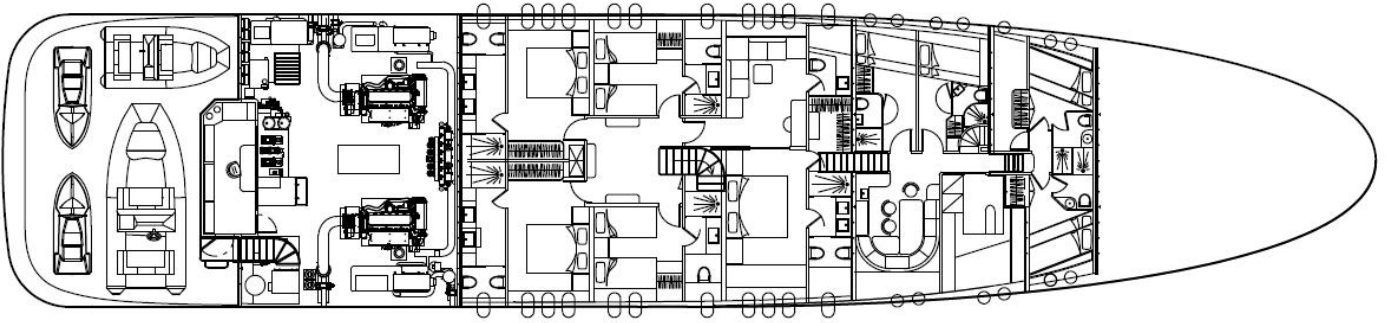

Option B:

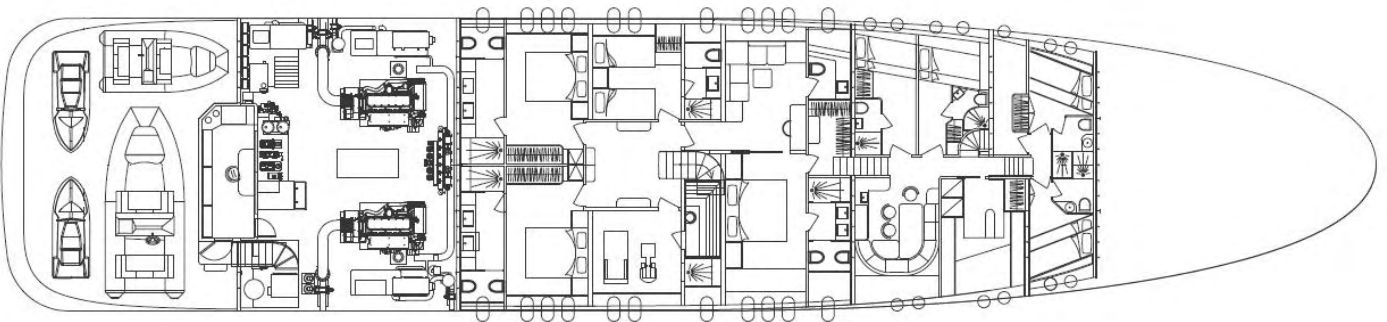

Option C:

